



FORT BEND COUNTY ENGINEERING

Fort Bend County, Texas

Richard W. Stolleis, P.E.
County Engineer

April 16, 2013

Commissioner Richard Morrison
Fort Bend County Precinct 1
1517 Eugene Heimann Circle, Suite 300
Richmond, Texas 77469

RE: Traffic/Safety Plan - West Tavener from Pink Taylor Run to Koym, Battle Road from FM 2919 to West Tavener and Powell Point School Road from FM 2919 to West Tavener to include placement of "No Trucks" signs

Dear Commissioner:

Fort Bend County Engineering has received and reviewed your request for "No Trucks" signs on Battle Road, Powell Point School Road and West Tavener Road due to safety concerns of heavy truck traffic damaging these roads. This traffic/safety plan will also include a 45 mph speed limit for West Tavener Road.

A copy of the traffic control plan is attached for your review. As per your request, Engineering will place an item on Commissioners Court agenda to set a public hearing. If you should have any questions, please give me a call.

Sincerely,

A handwritten signature in black ink, appearing to read "DeWayne O. Davis".

DeWayne O. Davis, P.E.
Engineer III

DOD/mjs

cc: Judge Robert E. Hebert, County Judge
Marc Grant - FBC Road & Bridge
Marc Grant - Signage Department
File

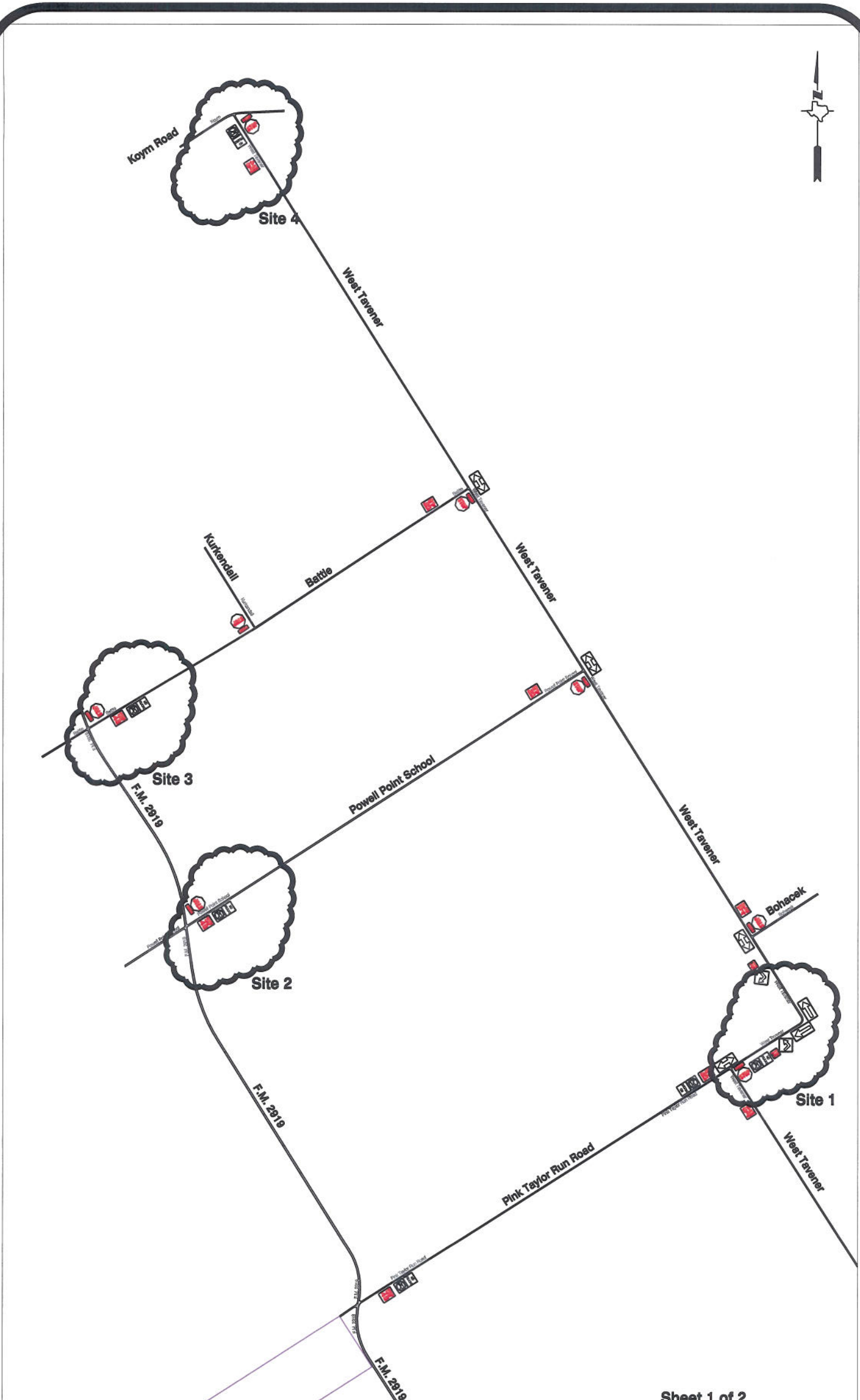

Sheet 1 of 2

Note:The purpose of this traffic control plan is to revise traffic control for various roads in the Kendleton area with the addition of "No Trucks" signs and speed limit signs as indicated on drawing. All other signs are existing.

| |
|----------------------------|
| Drawn By: L. Brdecka |
| Date: 4-12-13 |
| Approved By: DeWayne Davis |
| Date: 4-12-13 |
| Scale |
| N.T.S. |

| |
|---|
| Kendleton Area Control Map and Traffic Sign Layout |
| Fort Bend County Engineering Dept. 1124 Blume Road Rosenberg, Texas 77471 |

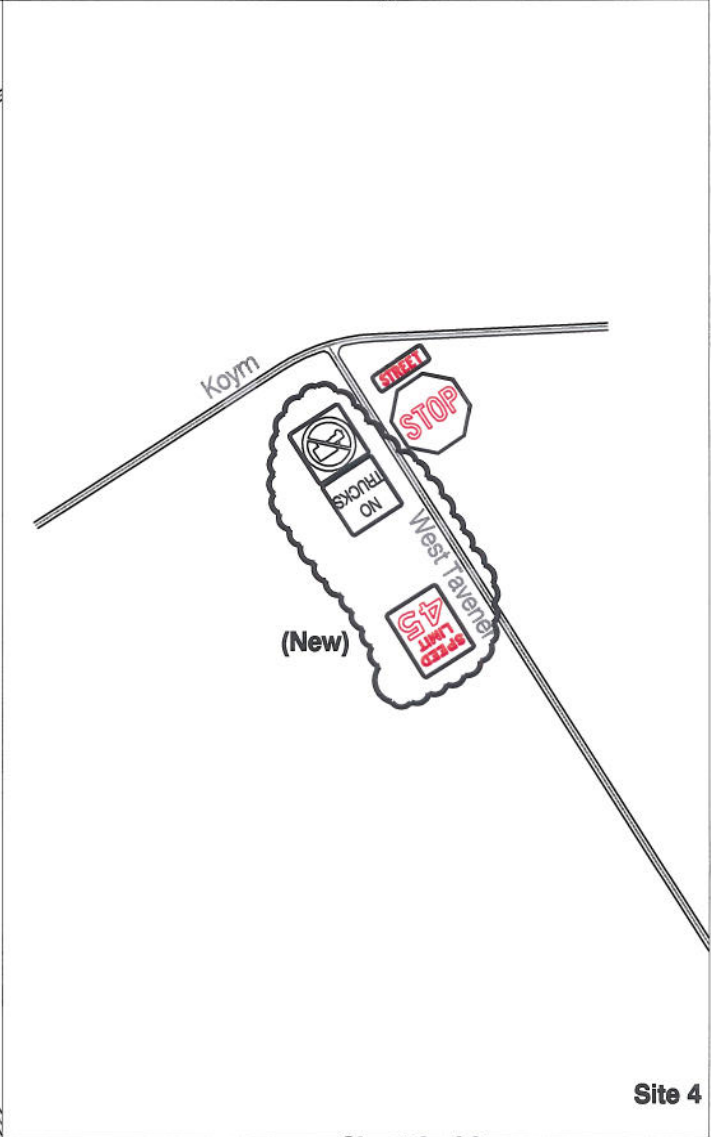
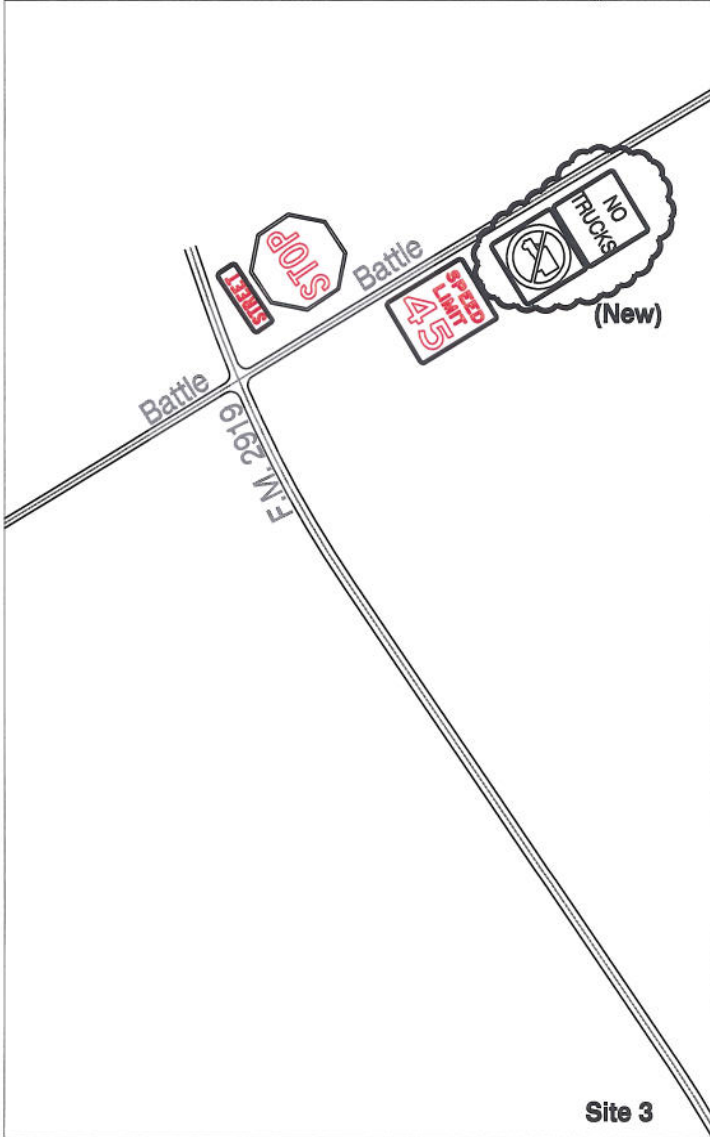
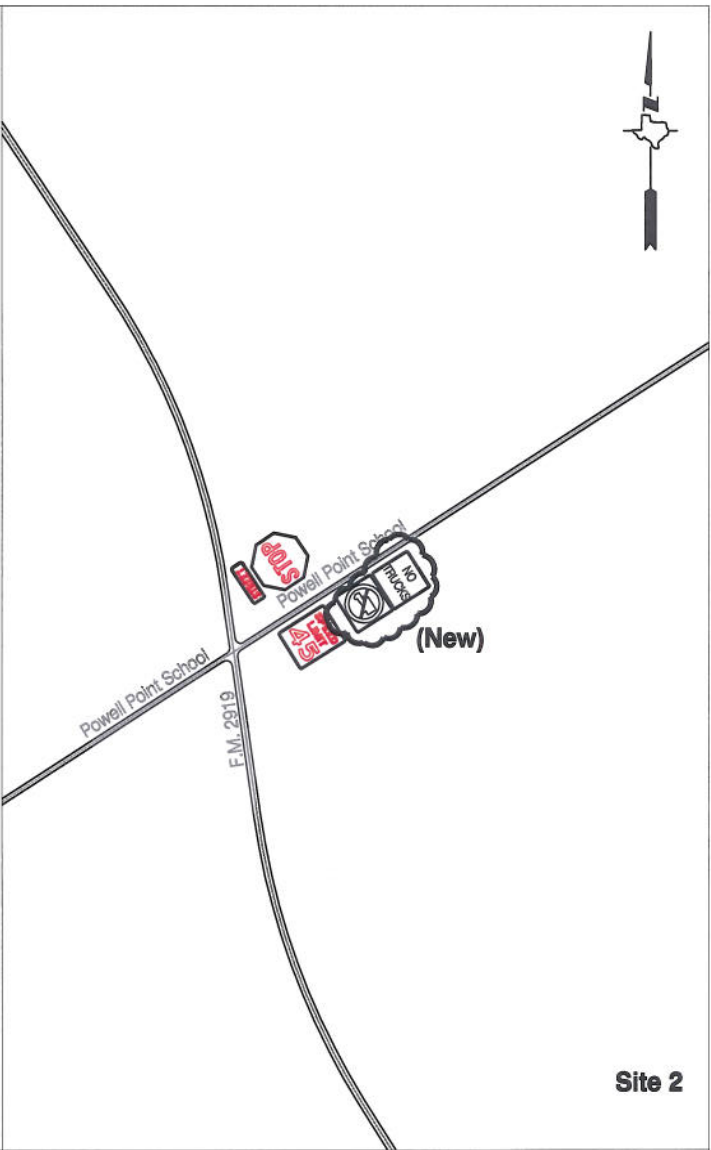
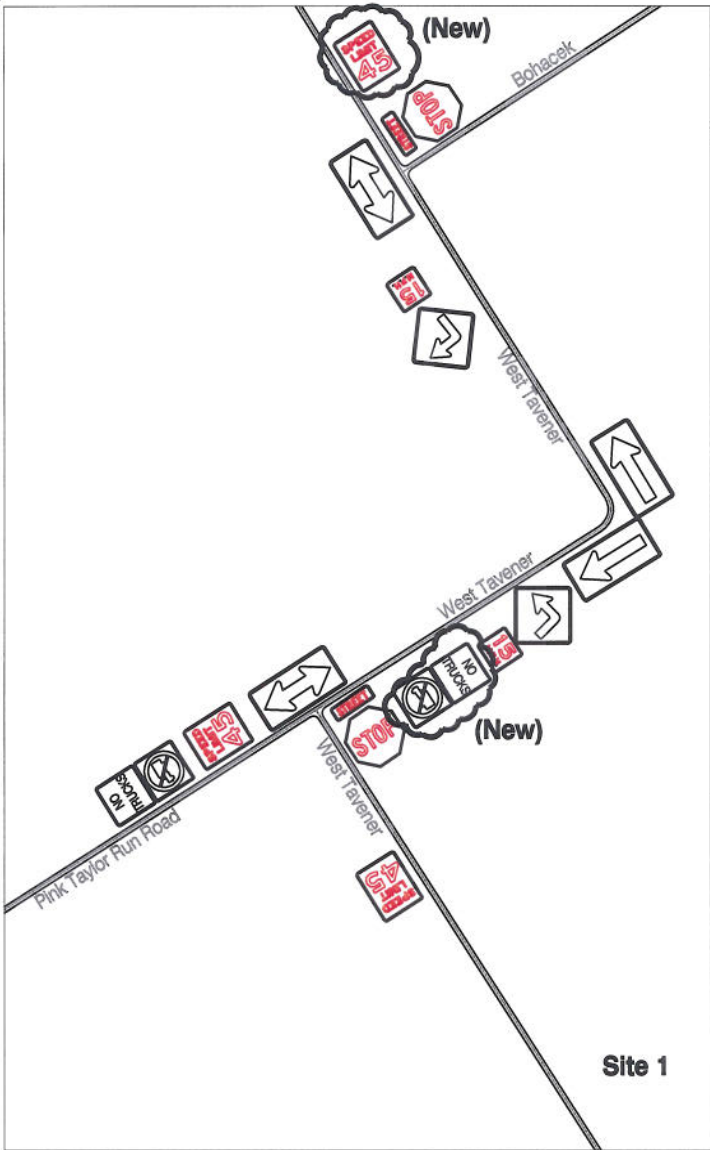

Sheet 2 of 2

Note:The purpose of this traffic control plan is to revise traffic control for various roads in the Kendleton area with the addition of "No Trucks" signs and speed limit signs as indicated on drawing. All other signs are existing.

Drawn By: L. Brdecka
 Date: 4-12-13
 Approved By: DeWayne Davis
 Date: 4-12-13
 Scale
N.T.S.

**Kendleton Area
 Control Map and
 Traffic Sign Layout**

Fort Bend County Engineering Dept.
 1124 Blume Road
 Rosenberg, Texas 77471