



## FORT BEND COUNTY ENGINEERING

Fort Bend County, Texas

Richard W. Stolleis, P.E.  
County Engineer

November 27, 2012

Commissioner W. A. "Andy" Meyers  
Fort Bend County Precinct 3  
22333 Grand Corner Drive  
Katy, Texas 77494

**RE: Traffic/Safety Study for Katy ISD – Garland McMeans Junior High School at Westheimer Parkway**

Dear Commissioner:

Fort Bend County Engineering has completed and recommends approval of the traffic control plans for Garland McMeans Junior High School to add "No Left Turn" signs at the parent drop off entrance to the school. The public hearing date for acceptance of the plan will be scheduled on the next available Commissioner's Court agenda.

A copy of the traffic control plan is attached for your review. If you should have any questions, please give me a call.

Sincerely,

A handwritten signature in black ink, appearing to read "Nathan D. Hatcher", is written over a horizontal line.

Nathan D. Hatcher  
Assistant to County Engineer

NDH/mjs

cc: Judge Robert E. Hebert, County Judge  
Marc Grant - FBC Road & Bridge  
Marc Grant - Signage Department  
Mr. John C. Bremer, Katy Ind. School District Police Dept., 20370 Franz Road,  
Katy, Texas 77449, [johncbremer@katyisd.org](mailto:johncbremer@katyisd.org)  
File

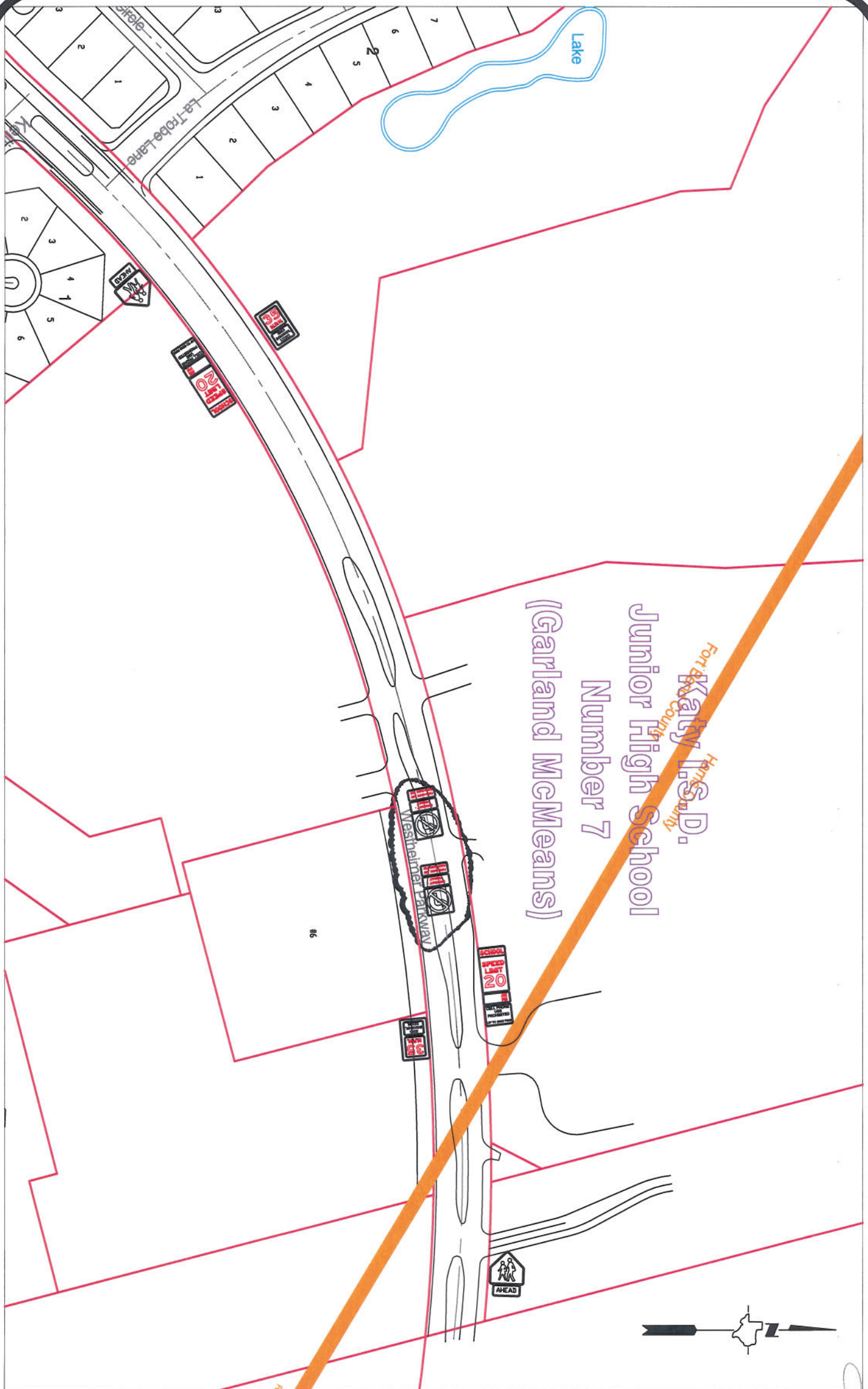

**Note:**

The purpose of this traffic control plan is to revise traffic control for Katy I.S.D. Junior High School No. 7 (Garland McMeans) with the addition of "No Left Turn During School Hours" signs as indicated on the drawing.

Drawn By: L. Brdecka

Date: 11-27-12

Approved By: Steven L. Evans

Date: 11-27-12

Scale

1" = 200'-0"

**Katy I.S.D. Junior High School No. 7  
(Garland McMeans)  
Control Map and Traffic Sign Layout**

Fort Bend County Engineering Dept.  
1124 Blume Road  
Rosenberg, Texas 77471