



FORT BEND COUNTY ENGINEERING

Fort Bend County, Texas

Richard W. Stolleis, P.E.
County Engineer

September 17, 2012

Commissioner W. A. "Andy" Meyers
Fort Bend County Precinct 3
22333 Grand Corner Drive
Katy, Texas 77494

**RE: Traffic/Safety Study for Katy ISD No. 17 – Roosevelt Alexander Elementary
(So. Fry Road at Peek Rd.)**

Dear Commissioner:

Fort Bend County Engineering has completed and recommends approval of the traffic control plan for Roosevelt Alexander Elementary School to prohibit turning at the median cut between the driveway on the west side of the school at Center Village Drive. This is to eliminate drivers from cutting into the established pickup/drop off line to the school. If there are no objections to the plan, a date to schedule the hearing will be on the next available Commissioner's Court agenda.

A copy of the traffic control plan is attached for your review. If you should have any questions, please give me a call.

Sincerely,

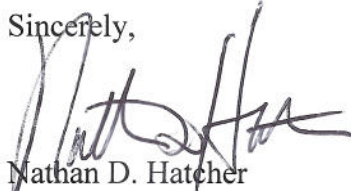

Nathan D. Hatcher
Assistant to County Engineer

NDH/mjs

cc: Judge Robert E. Hebert, County Judge
Marc Grant - FBC Road & Bridge
Marc Grant - Signage Department
Mr. John C. Bremer, Katy Ind. School District Police Dept., 20370 Franz Road,
Katy, Texas 77449, johncbremer@katyisd.org
File

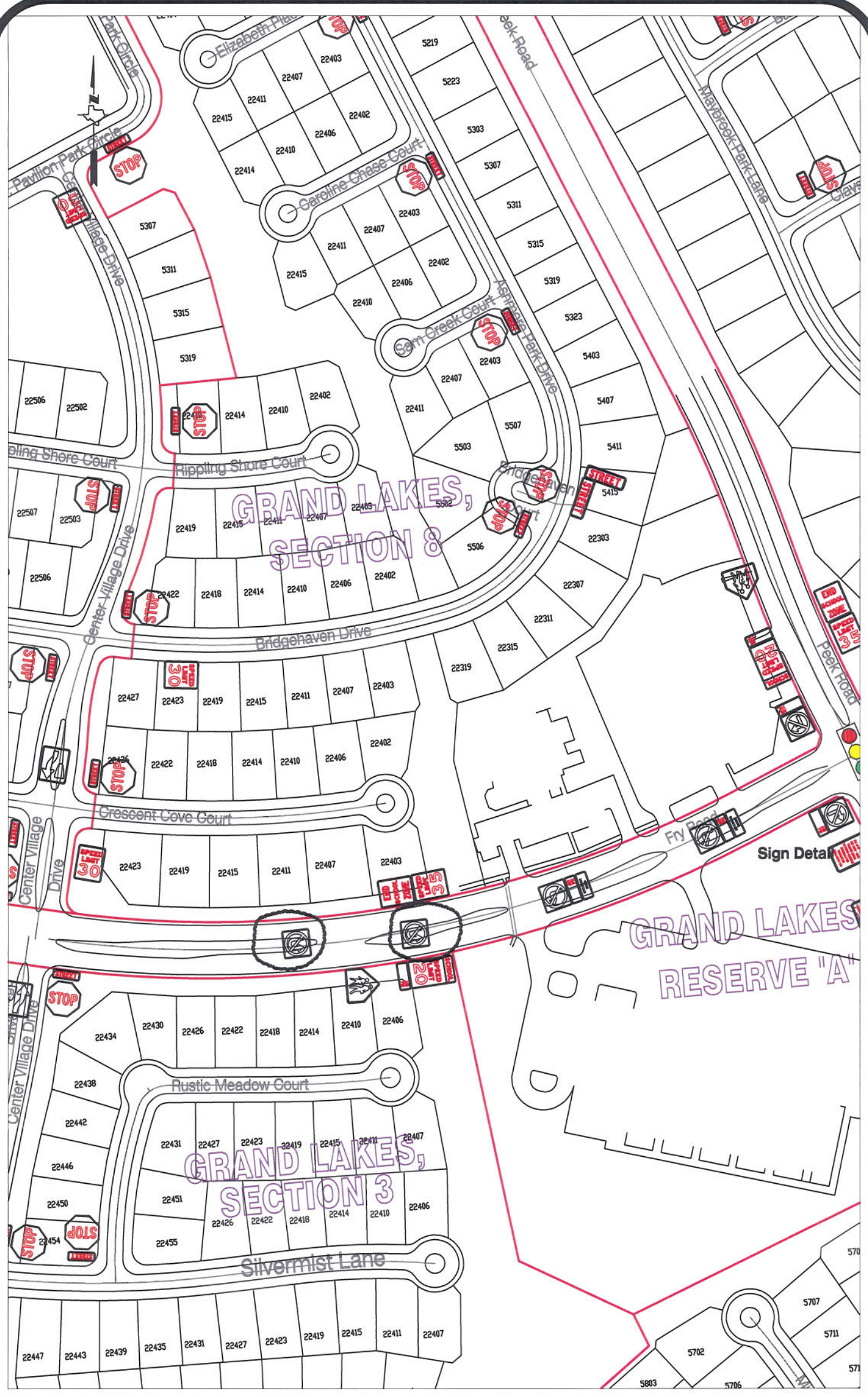

Note:
 The purpose of this traffic control plan is to revise traffic control for Roosevelt Alexander Elementary School (Grand Lakes Reserve 'A') with the addition of modified "No Right Turn During School Hours" as indicated.

Drawn By: L. Brdecka
 Date: 9-17-12
 Approved By: Nathan Hatcher
 Date: 9-17-12
 Scale
 1" = 200'-0"

Roosevelt Alexander Elementary School
 (Grand Lakes Reserve 'A')
 Revised
Control Map and Traffic Sign Layout
 Fort Bend County Engineering Dept.
 1124 Blume Road
 Rosenberg, Texas 77471