



FORT BEND COUNTY ENGINEERING

Fort Bend County, Texas

D. Jesse Hegemier
County Engineer

October 29, 2010

Commissioner Grady Prestage
Fort Bend County Precinct 2
3030 Texas Parkway, Suite 213
Missouri City, Texas 77459

RE: Summer Park Subdivision - Traffic Control Plan

Take all appropriate action on Petition from the Summer Park Apartment Community requesting that Fort Bend County place signs at the locations reflected on the traffic control plan prohibiting overnight parking of commercial motor vehicles pursuant to Texas Transportation Code Ann. §545.307

Dear Commissioner:

The Fort Bend County Engineering Department has completed a traffic control plan for the Summer Park Apartment Community to prohibit overnight truck parking of commercial motor vehicles within the subdivision. A petition has valid signatures of 26% of the residents within the subdivision. This meets the 25% required. Fort Bend Engineering has no objection to placing "Overnight Parking of Commercial Motor Vehicles is Prohibited" signs at the locations indicated on the attached traffic control plan, pursuant to Texas Transportation Code Ann. §545.307. The petition is dated October 28, 2010 and is on file in the Engineering Office.

The Engineering Department recommends acceptance of the traffic control plan as submitted. The public hearing date for acceptance of the plan is being scheduled. A copy of the traffic control plan is attached for your review. If you should have any questions, please give me a call.

Sincerely,

A handwritten signature in cursive script, reading "DeWayne O. Davis".

DeWayne O. Davis, P.E.
Engineer III

DOD/mjs

cc: Judge Robert E. Hebert, County Judge
Marc Grant - FBC Road & Bridge
Marc Grant - Signage Department
File

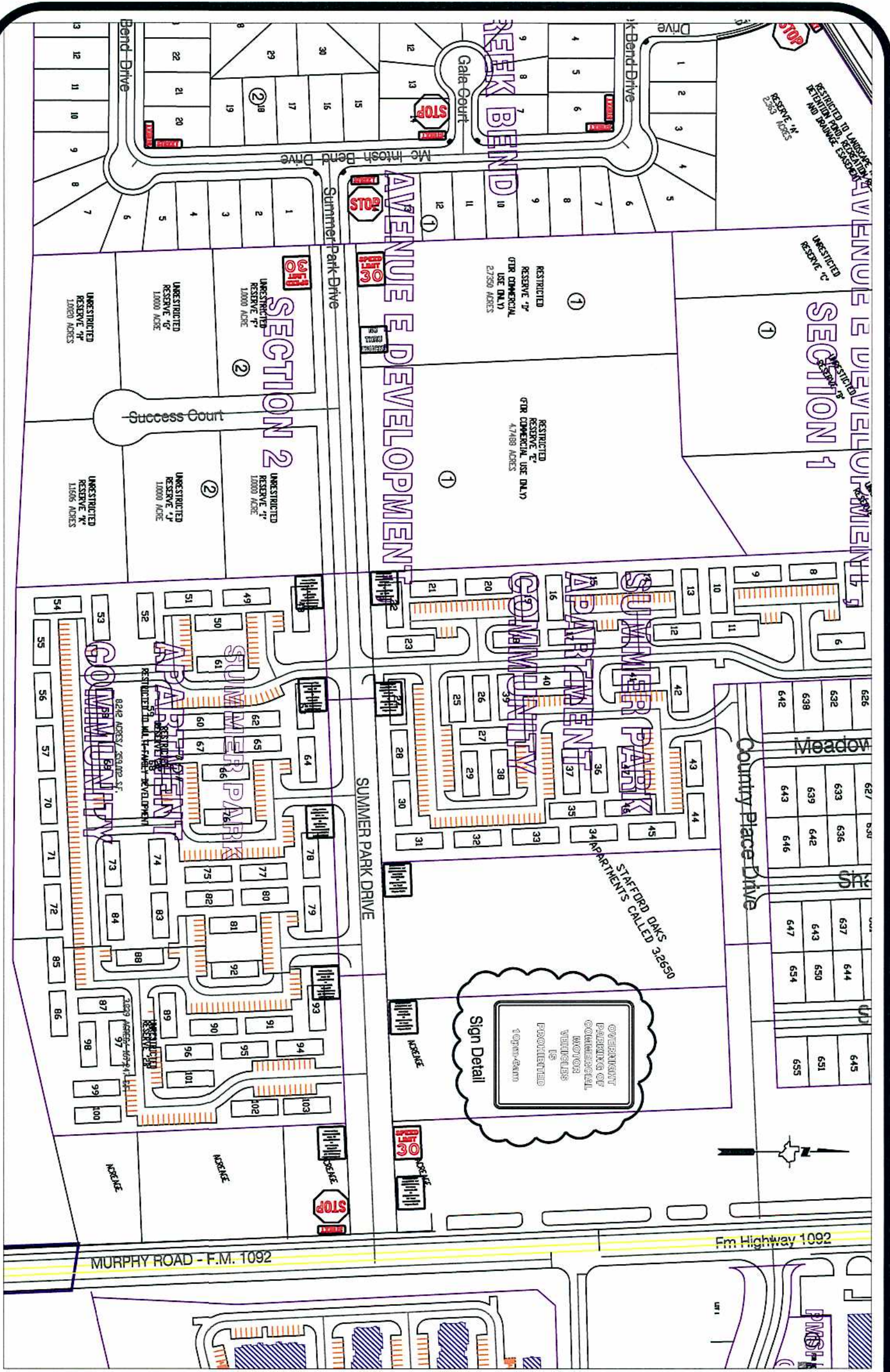

Note:

The purpose of this traffic control plan is to revise traffic control for Summer Park Drive with the addition of "No Overnight Parking Of Commercial Vehicles" signs as indicated.

Drawn By: L. Brdecka
Date: 9-30-10
Approved By: DeWayne Davis, P.E.
Date: 9-30-10
Scale
1" = 200'-0"

**Summer Park Drive
Control Map and
Traffic Sign Layout**

Fort Bend County Engineering Dept.
1124 Blume Road
Rosenberg, Texas 77471